

Power and multimedia unit with unique design dedicated to mounting on the table top / desk using feet. It ensures easy access to power and multimedia sockets and is a perfect solution for dispatcher, service and laboratory workstations. For its assembling are used standard Ø60 holes.

**magnet-tube** gives the opportunity to meet the individual client's needs as it's available in versions from 2 to 6 modules and in a few colour variants: anodized on black, natural or painted in white, red, yellow, green or blue colour.

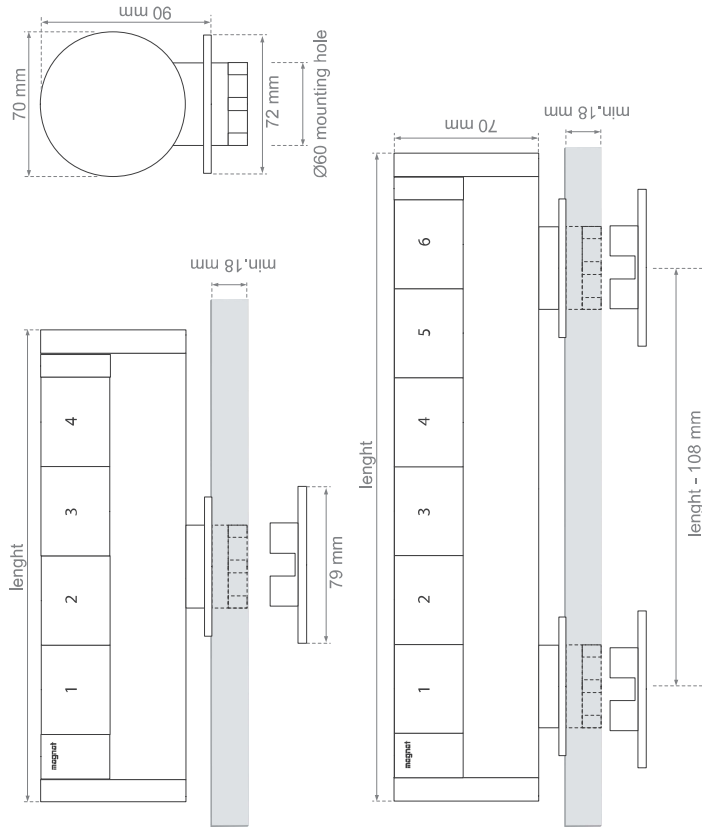

### Dimensions of different versions (length of housing)

version	2-module	3-module	4-module	5-module	6-module	7-module and more
length	141 mm	184 mm	227 mm	270 mm	313 mm	55 + (43 * number of modules)

\* Specified dimensions don't concern configurations with UK power sockets nor the ones without multimedia ports / USB chargers. This kind of dimensions are available on request.

Insert the housing into standard Ø60 hole, use screws dedicated to plastics and lock the bolts.

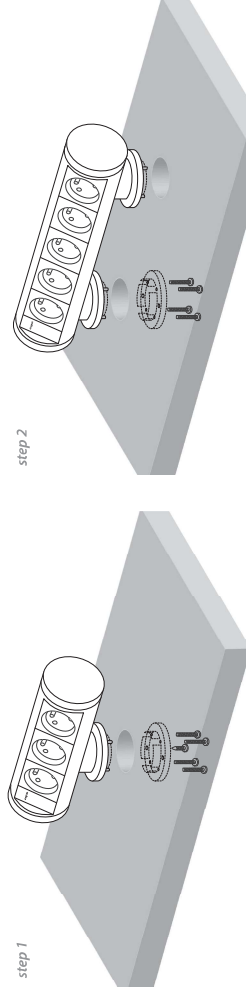

In case of the table top thickness bigger than 30mm, there's a possibility of using custom-made mounting brackets.



WHITE  
(RAL9003)



BLACK  
(RAL9005)



NATURAL ANODIZED  
ALUMINIUM